

# BOWER HILL ROAD SANITARY SEWER LINE EXTENSION PETERS CREEK SANITARY AUTHORITY

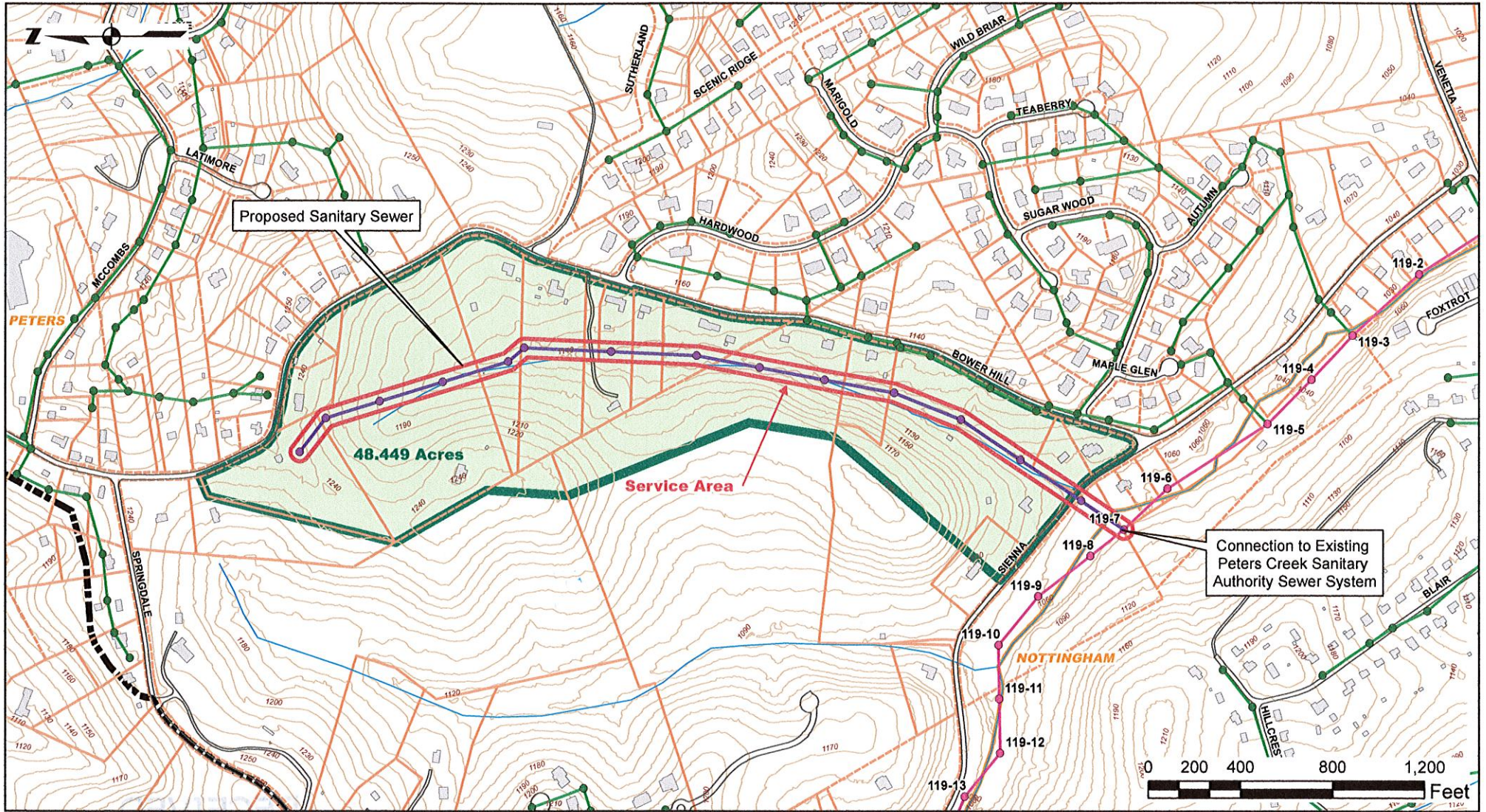

Proposed Sanitary Sewer

48,449 Acres

Service Area

Connection to Existing  
Peters Creek Sanitary  
Authority Sewer System

- Proposed Manholes
- PCSA Interceptor Structures
- Peters Twp Parcels
- Proposed Alignment
- PCSA Interceptor
- Future Growth Areas
- Proposed Area
- PCSA Structures
- PCSA Boundary
- PCSA Pipes
- Municipal Boundary

**Lennon, Smith, Souleret  
Engineering, Inc.**  
Civil Engineers and Surveyors

846 Fourth Avenue  
Coraopole, PA 15108  
(412) 264-4400  
(412) 264-1200 Fax  
lss@lsse.com  
www.lsse.com

**Bower Hill Road  
Sanitary Sewer Line Extension**  
Peters Creek Sanitary Authority  
3502 Lincoln Avenue  
Finleyville, PA 15332

P:\11\1117\1117.dwg - 11/11/11 - 11:11:11 AM